



Part# 1049702CD

2003-2007 Cat-Back 6.0L Ford Powerstroke
F250/F350 2WD/4WD (Dual Outlet System)
(Off-road only for models equipped with Converter)
-- Not for Commercial Trucks --

Removal of Stock System:

- 1.) Remove the nut from the band clamp in front of the muffler with a 15mm wrench or socket.
- 2.) Remove the rear exhaust from the rubber hangers. Remove the bottom shock bolt at the rear of the truck & separate the stock exhaust at the slip joint at the muffler.
- 3.) Remove the muffler and tail pipe from under the truck, and then re-install the bottom shock bolt.
- 4.) Remove the extension pipe from the catalytic converter using a 15mm deep socket on the band clamp on the outlet of the catalytic converter.

Installation of BD Stainless Exhaust:

(Installation tip: Temporarily hang the muffler and tail pipe in place using the two OEM rubber hangers and measure to the outlet of the converter to determine the length needed. The extension pipe supplied is pre-cut for the 172" wheelbase truck. All other wheelbases will need the extension pipe cut to length.)

- 1.) Install the muffler over the extension(s). The "T" hanger-clamp is used at the rear of the muffler and installed into the OEM rubber hangers above. (Note: The muffler outlets are positioned vertically.)
- 2.) Install the passenger side tail pipe first. This pipe goes to the top outlet on the dual outlet muffler. Do not tighten as the rest of the kit needs to be installed to allow for adjustments.
- 3.) Install the over-axle pipe to the bottom outlet of the muffler.
- 4.) Attach the driver's side tail section to the over-axle pipe to complete the drivers side portion of the exhaust.
- 5.) Lift the tailpipe & hanger directly above the existing hole and fasten to the frame using the supplied 7/16" nut & bolt.
- 6.) Install the 5" stainless steel tip to your desired position to complete the installation.
- 7.) Install the clamps around the pipes where needed. Be sure that the exhaust is in place before tightening any clamps. Starting at the down-pipe, tighten all connections.

BD recommends that exhaust systems be installed by a trained automotive technician. If these parts are installed by a do-it-yourself person, or end user, please take all necessary precautions to ensure a safe installation.

BD Engine Brake Inc.

Plant Address: 33541 MacLure Rd. Abbotsford, BC, Canada V2S 7W2

U.S. Shipping Address: 88-446 Harrison St, Sumas, WA 98295 U.S. Mailing Address: P.O. Box 231, Sumas, WA 98295

Phone: 604-853-6096 | Fax: 604-853-8749 | Internet: www.bd-power.com



Part# 1049702CD

Kit Contents:

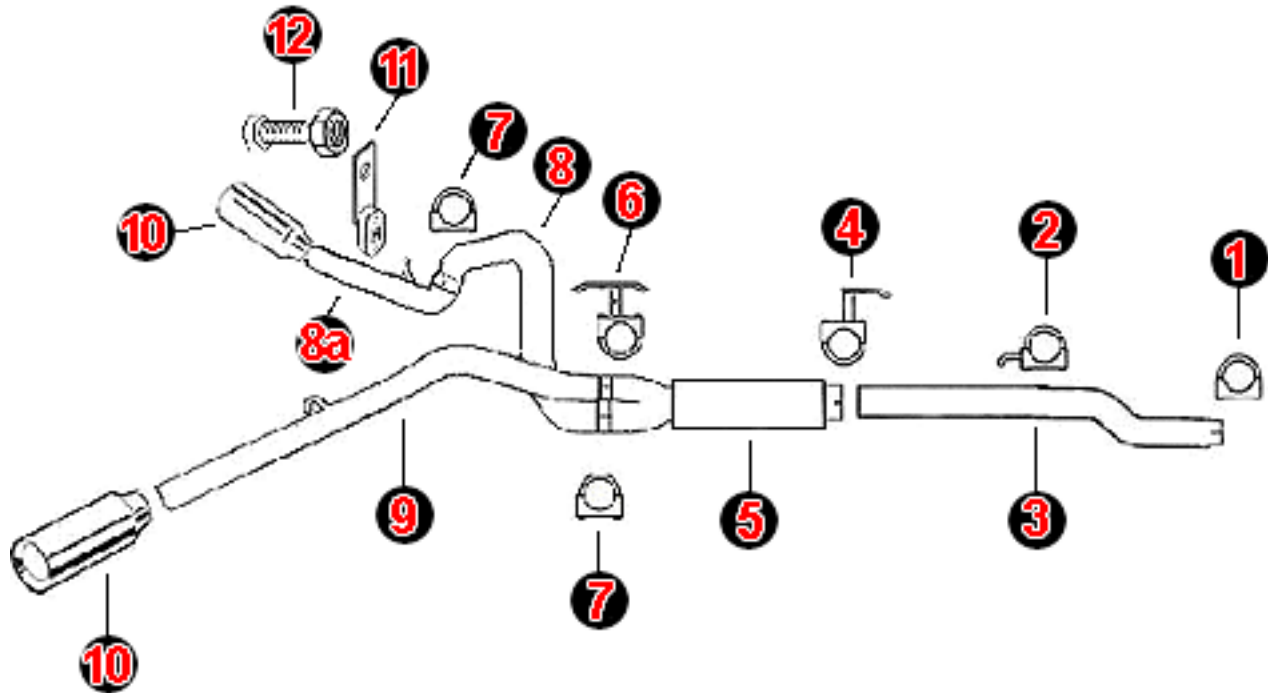

- | | | | |
|-----|---------------------------------------|-----|-----------------------------|
| 1. | 3 ½" Exhaust Clamps [1] | 9. | Right Tail Pipe [1] |
| 2. | 4" Exhaust Clamp w/ hook [1] | 10. | Polished 5" Exhaust Tip [2] |
| 3. | 45 1/2" Intermediate Pipe [1] | 11. | Bracket [1] |
| 4. | 4" Exhaust Clamp w/ single hanger [1] | 12. | Nut/Bolt [1] |
| 5. | Dual Outlet Muffler [1] | | |
| 6. | 4" Exhaust Clamp w/ double hanger [1] | | |
| 7. | 4" Exhaust Clamp [2] | | |
| 8. | Left Over Axle Pipe [1] | | |
| 8a. | Left Tail Pipe [1] | | |

BD Engine Brake Inc.

Plant Address: 33541 MacLure Rd. Abbotsford, BC, Canada V2S 7W2

U.S. Shipping Address: 88-446 Harrison St, Sumas, WA 98295 U.S. Mailing Address: P.O. Box 231, Sumas, WA 98295

Phone: 604-853-6096 | Fax: 604-853-8749 | Internet: www.bd-power.com