



Part# 1049701D

1999-2003 Turbo-Back 7.3L Ford Powerstroke
 F250/F350 2WD/4WD (Dual System)
 (Off-road only for models equipped with Converter)
-- Not for Commercial Trucks --

Removal of Stock System:

- 1.) Remove the nut from the band clamp in front of the muffler with a 15mm wrench or socket.
- 2.) Remove the rear exhaust from the rubber hangers. Remove the bottom shock bolt at the rear of truck & separate the stock exhaust at the slip joint at the muffler.
- 3.) Remove the muffler and tail pipe from under the truck, and then re-install the bottom shock bolt.
- 4.) Remove the extension pipe at flange using a 15mm deep socket.
- 5.) Remove the down pipe. From under the hood, remove the band clamp with a 11mm wrench/socket at the turbo and then cut the pipe in front of the transmission cross member to remove.

(Note: The stock down-pipe can be removed in one piece by removing the transmission cross-member. It is recommended that this procedure be done only by qualified trained professionals using tools and equipment designed for safety to carry out this process.)

Installation of BD Stainless Exhaust:

- 1.) Install the down-pipe, flare side to turbo using the stock band clamp. Do not fully tighten until all components are in place.
- 2.) Install the Mid-pipe using the pre-welded hanger into the OEM rubber hanger located on the frame.
- 3.) Install the extension pipe over the down-pipe. A 34" extension pipe is included to accommodate each wheelbase. (Installation tip: Temporarily hang the muffler and tail pipe in place using the OEM rubber hangers and measure to the down pipe to determine the length needed)
- 4.) Install muffler over the extension(s). The "T" hanger-clamp is used at the rear of the muffler and installed into the OEM rubber hangers above.
- 5.) Install the passenger side tail pipe first. This pipe goes to the top outlet on dual outlet muffler. Use the 4" "T" hanger clamp provided, but do not tighten yet.
- 6.) Install the over-axle pipe to the bottom outlet of the muffler.
- 7.) Attach the driver's side tail section to the over-axle pipe to complete the driver's side portion of the exhaust.
- 8.) Lift the tailpipe & hanger directly above the existing hole and fasten to the frame using the supplied 7/16" nut & bolt.
- 9.) Install clamps around pipes where needed, but be sure the exhaust is in place before tightening any clamps.
- 10.) Starting at the down-pipe, tighten all connections.

BD recommends that exhaust systems be installed by a trained automotive technician. If these parts are installed by a do-it-yourself person, or end user, please take all necessary precautions to ensure a safe installation.

BD Engine Brake Inc.

Plant Address: 33541 MacLure Rd. Abbotsford, BC, Canada V2S 7W2

U.S. Shipping Address: 88-446 Harrison St, Sumas, WA 98295 U.S. Mailing Address: P.O. Box 231, Sumas, WA 98295

Phone: 604-853-6096 | Fax: 604-853-8749 | Internet: www.bd-power.com



Part# 1049701D

Kit Contents:

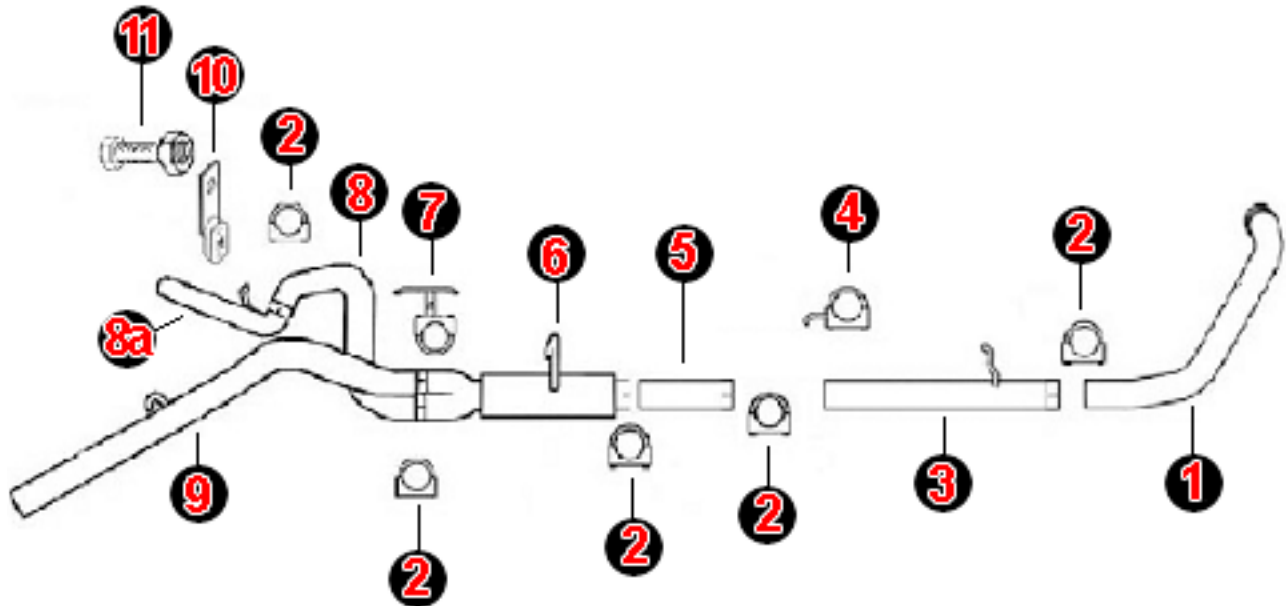

- | | | | |
|-----|--------------------------------|-----|--------------------------------|
| 1. | Turbine Outlet Pipe [1] | 9. | Right Tail Pipe [1] |
| 2. | 4" Exhaust Clamps [5] | 10. | Bracket [1] |
| 3. | 53 ½" Intermediate Pipe [1] | 11. | Nut/Bolt [1] |
| 4. | 4" Exhaust Clamp w/ hook [1] | 12. | (not shown) 5" Exhaust Tip [2] |
| 5. | 34" Intermediate Pipe [1] | | |
| 6. | Muffler [1] | | |
| 7. | 4" Exhaust Clamp w/ hanger [1] | | |
| 8. | Left Over Axle Pipe [1] | | |
| 8a. | Left Tail Pipe [1] | | |

BD Engine Brake Inc.

Plant Address: 33541 MacLure Rd. Abbotsford, BC, Canada V2S 7W2

U.S. Shipping Address: 88-446 Harrison St, Sumas, WA 98295 U.S. Mailing Address: P.O. Box 231, Sumas, WA 98295

Phone: 604-853-6096 | Fax: 604-853-8749 | Internet: www.bd-power.com